



METACAST

INVESTMENT POWDER

SCP is unrivalled in developing and improving our investment powders to meet the demands of the developing world of direct casting 3D printed resin or wax patterns.

3D printing is fast moving in terms of technology, resin types and the print demands, SCP are committed to continually developing our investment powders to maintain the industry's needs.

Metacast has been extensively tried & tested in some of the most renown factories throughout the world, to offer continued improvement on direct casting of 3D printed resin or wax models, from all types of resin and 3D printing manufacturers for castings far more superior than just optimal results.

Evolving - what makes Metacast significantly better than other manufacturers of investment powder is the ability to fast fire a single flask, within 6 hours from mixing the investment powder to obtaining a clean smooth surface casting. This has also vastly improved an already outstanding clean off after casting.

- Fast Fire burnout cycle
- High temperature burnout resistance
- Consistently smooth surfaces
- Easy Clean Off
- Delicate details, replicated time and time again.



METACAST

INVESTMENT POWDER

TECHNICAL DATA

Powder / Water Ratio	100/38
Working Time @ 25°C Slurry Temp	8-9 min.
Gloss Off Time @ 25°C Slurry Temp	11 - 13 min.
Thermal Expansion At 750°C	1.2%

BURNOUT CYCLE

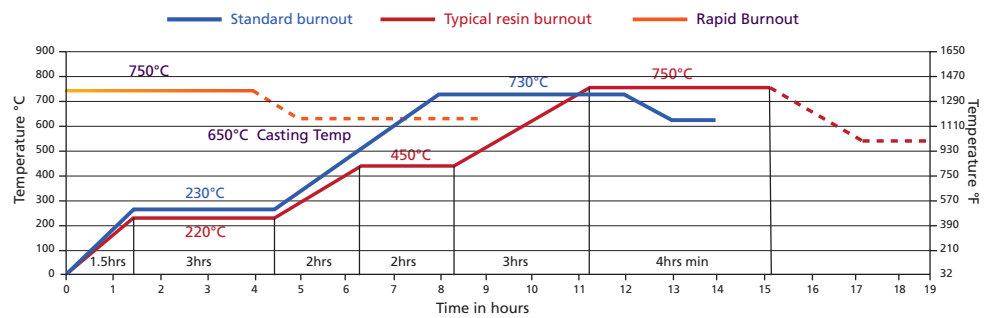

MIXING INSTRUCTIONS



SIAM CASTING POWDERS LTD.

Conventional Mixing

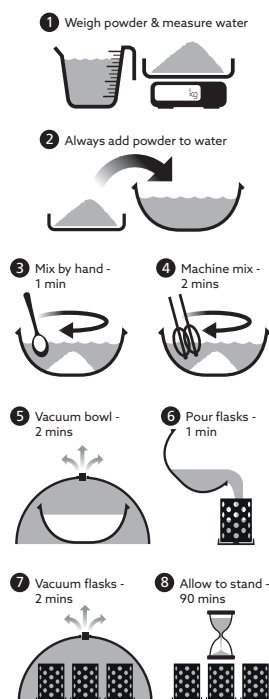

Vacuum Mixing

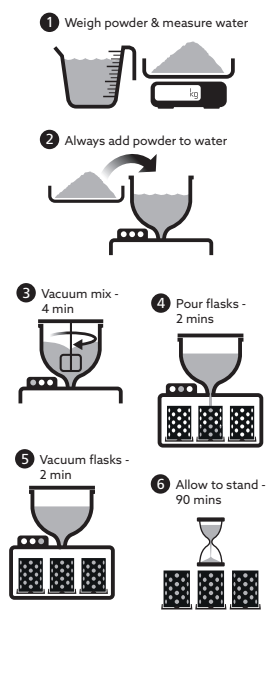

Water/Powder Ratio 38:100	
Conventional Mixing	Time (Mins)
Add Powder To Water	-
Hand Mix	1
Machine Mix	2
Vacuum Bowl	2
Pour Flasks	1
Vacuum Flasks	2
Total Mixing Time	8

Water/Powder Ratio 38:100	
Vacuum Mixing	Time (Mins)
Add Powder To Water	-
Mix Under Vacuum	4
Pour Flasks	2
Hold Under Vacuum	2
Total Mixing Time	8